

FG44-61369-P01

SHT 1.1

NOTES:

1. INCREASED PRESSURE AT THE SOUND INLET CAUSES A POSITIVE GOING VOLTAGE TO APPEAR AT THE OUTPUT TERMINAL, RELATIVE TO THE NEGATIVE TERMINAL.

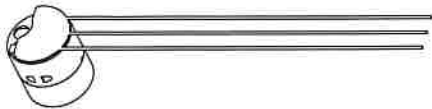
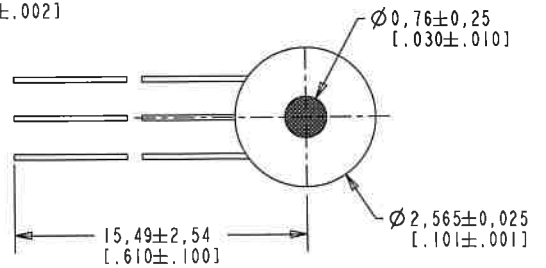
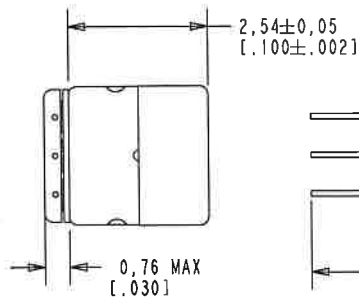
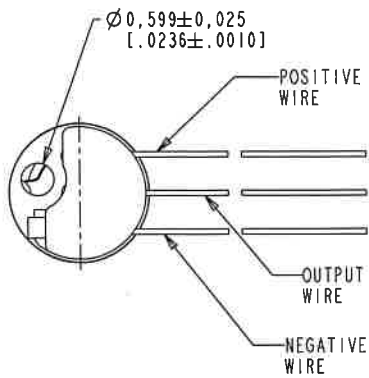

SCALE 5:1
 NOMINAL WEIGHT 0.041 GRAMS
 DIMENSIONS IN MILLIMETERS [INCHES]

Revision	C.O. #	Implementation Date	RELEASE LEVEL	REVISION
C	M10108119	2-27-19	Active	C
B	M10107663	7-23-18		
A	M10106656	4-20-16		

SCALE:	10:1	DR. BY	DATE
DO NOT SCALE DRAWING		NANC	4-20-16
TITLE: MICROPHONE		GJP	4-20-16
OUTLINE DRAWING		APP. BY	DATE
FG44-61369-P01		GJP	4-20-16
SHT 1.1			

KNOWLES CORPORATION

AC111ASIZE.FRM REV: D

RoHS COMPLIANT

SENSITIVITY IN dB RELATIVE TO 1.0 VOLT/0.1 Pa (N/M²) FOR CONDITIONS SHOWN BELOW

TYPICAL SENSITIVITY

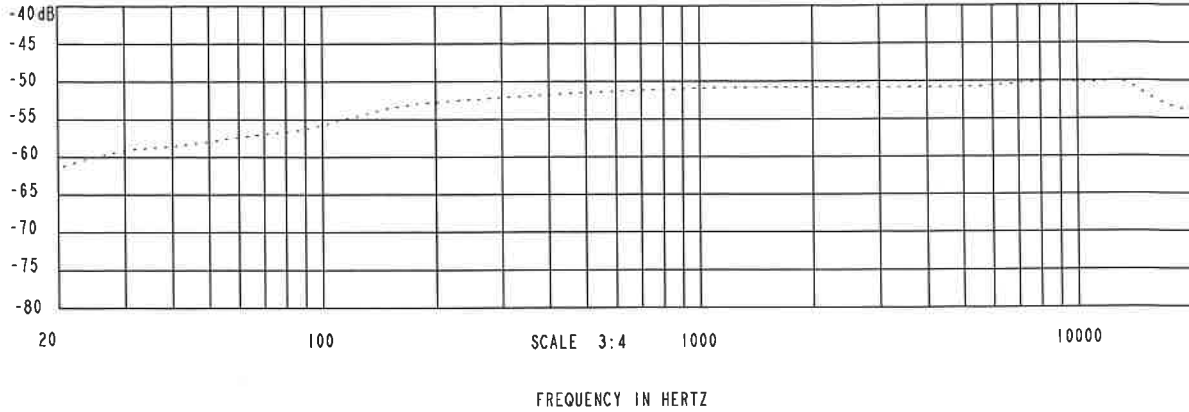

SENSITIVITY MEASURED IN A PRESSURE CAVITY UNDER THE NOMINAL CONDITIONS SHOWN BELOW

POWER REQUIREMENT					
PARAMETER	UNIT	MINIMUM	NOMINAL	MAXIMUM	REMARKS
DC POWER SUPPLY	VDC	0.9	1.14	1.6	-

PERFORMANCE						
PARAMETERS	UNIT	MINIMUM	NOMINAL	MAXIMUM	REMARKS	
SENSITIVITY	100 Hz	dB	-7.0	-5.0	-3.0	re SENSITIVITY AT 1 kHz
	1000 Hz	dB	-54.0	-51.0	-48.0	dB re 1V/0.1Pa
	10000 Hz	dB	-2.0	1.0	4.0	re SENSITIVITY AT 1 kHz
AMPLIFIER CURRENT DRAIN	μA	-	19	30	-	
OUTPUT LOAD VOLTAGE	V _L	0.22	0.4	0.58	OPEN LOAD	
A-WEIGHTED NOISE	dB(A)	-	26.0	29.0	INPUT REFERRED NOISE, dB(A) SPL, re SENSITIVITY AT 1kHz	
OUTPUT IMPEDANCE	Ohms	6000	8000	10000	-	

- NOTES: 1. CASE CONNECTED TO NEGATIVE TERMINAL.
 2. SENSITIVITY AND NOISE VALUES INDICATED ON THIS SPECIFICATION ARE VALID AT 1.14 VDC AND 909KOhm//<1500pF LOAD IMPEDANCE TYPICAL TEST ENVIRONMENT: 50% RH, 21°C(70°F)



PORT LOCATION: 12N

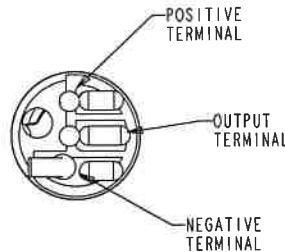

TERMINAL DEFINITION

KNOWLES RESERVES THE RIGHT TO MAKE CHANGES TO IMPROVE RELIABILITY AND PERFORMANCE OF THE PRODUCT

KNOWLES CORPORATION

Revision	C.O. #	Implementation Date	RELEASE LEVEL	REVISION
C	M10108119	2-27-19	Active	C
B	M10107663	7-23-18		
A	M10106656	4-20-16		

WHEN TEST LIMITS ARE USED TO ESTABLISH INCOMING INSPECTION ACCEPTANCE/REJECTION CRITERIA, CORRELATION OF TEST EQUIPMENT WITH KNOWLES IS ALSO REQUIRED FOR ELIMINATION OF EQUIPMENT AND TEST METHOD VARIATION		DR. BY	DATE
		NANC	4-20-16
TITLE: MICROPHONE		CK. BY	DATE
PERFORMANCE SPECIFICATION		GJP	4-20-16
FC44-61369-P01		APP. BY	DATE
2.1		GJP	4-20-16

RoHS COMPLIANT

A) 1/3 OCTAVE INPUT REFERRED NOISE

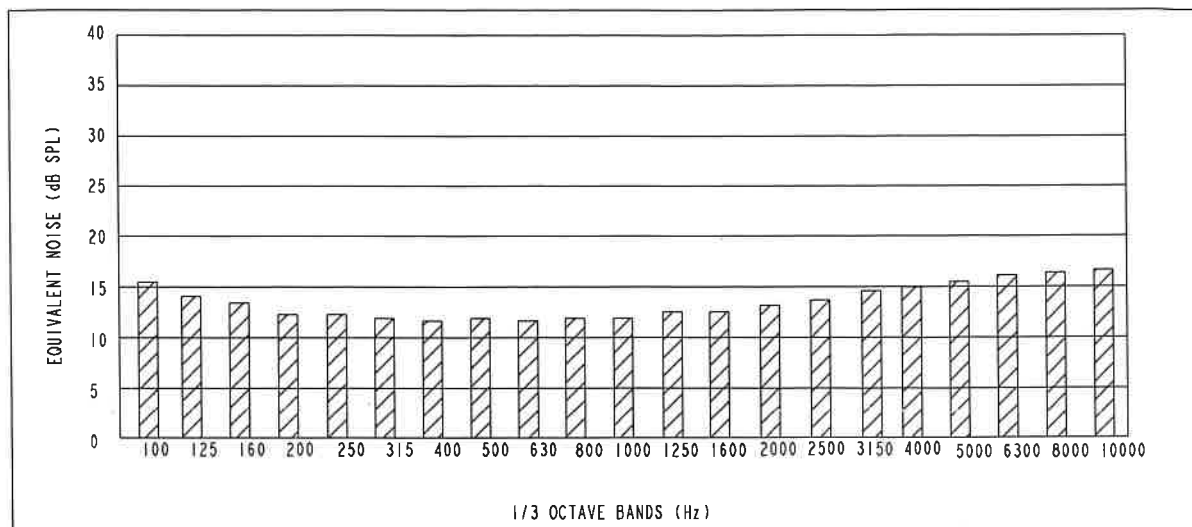

B) PERFORMANCE

PERFORMANCE						
PARAMETERS		UNIT	MINIMUM	NOMINAL	MAXIMUM	REMARKS
POWER SUPPLY REJECTION RATIO (PSRR)	1000 Hz	dB	-	-32	-20	SUPPLY VOLTAGE @ 0.9 VDC
INPUT REFERRED VIBRATION SENSITIVITY	1000 Hz	dB SPL	-	-	57	BLOCKED PORT; 1g ACCELERATION
HUMIDITY COEFFICIENT	1000 Hz	dB		0.06		PER %RH
TEMPERATURE RANGE	OPERATION	°C(°F)	-17(1.4)	-	63(145.4)	CELSIUS(FAHRENHEIT)
	STORAGE	°C(°F)	-40(-40)	-	63(145.4)	CELSIUS(FAHRENHEIT)
ESD TOLERANCE	MIL-STD-750 CLASS 2 RATING EOS/ESD-S5.1-1993 CLASS 2 RATING					

KNOWLES RESERVES THE RIGHT TO MAKE CHANGES TO IMPROVE RELIABILITY AND PERFORMANCE OF THE PRODUCT

Revision	C.O. #	Implementation Date	RELEASE LEVEL	REVISION
C	MID108119	2-27-19	Active	C
B	MID107663	7-23-18		
A	MID106656	4-20-16		

KNOWLES CORPORATION

WHEN TEST LIMITS ARE USED TO ESTABLISH INCOMING INSPECTION ACCEPTANCE/REJECTION CRITERIA, CORRELATION OF TEST EQUIPMENT WITH KNOWLES IS ALSO REQUIRED FOR ELIMINATION OF EQUIPMENT AND TEST METHOD VARIATION

TITLE: MICROPHONE
PERFORMANCE SPECIFICATION

FC44-61369-P01
2.2

DR. BY	DATE
NANC	4-20-16
CR. BY	DATE
GJP	4-20-16
APP. BY	DATE
GJP	4-20-16